

SURFACE MOUNTED

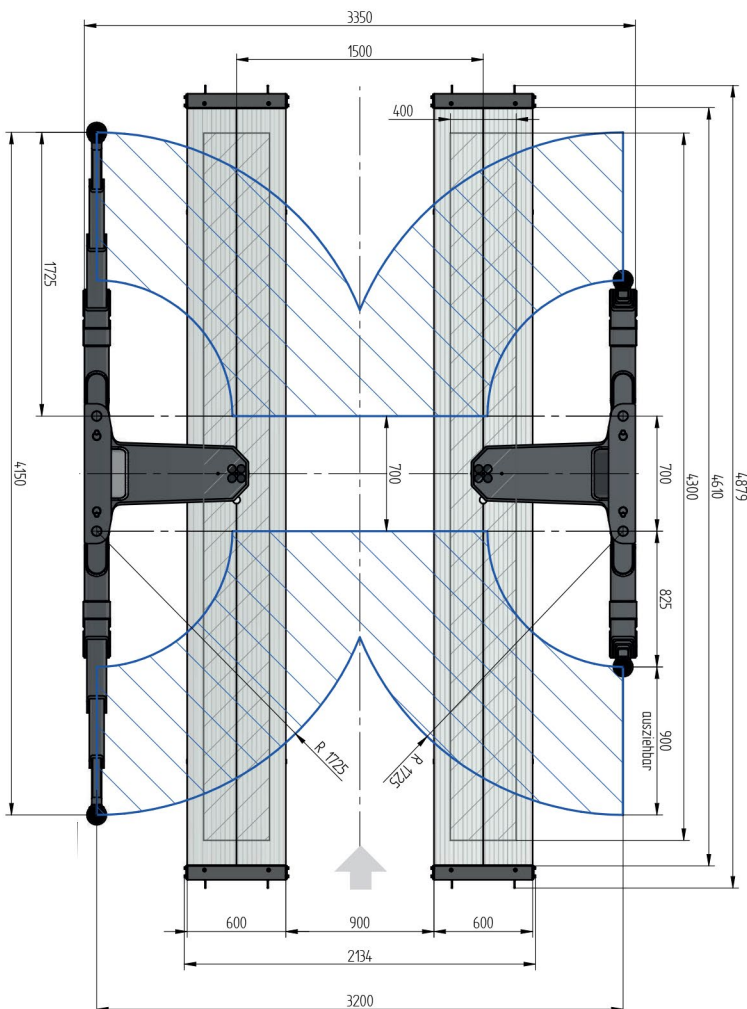

TECHNICAL DATA

capacity	5000 kg
wheel free lift	5000 kg
effect. raise height platform	1995 mm
effect. raise height wheel free unit	1979 mm
platform length	4800 mm
platform height	180 mm
drive over height wheel free unit	120 mm
piston diameter	123 mm
piston distance	1500 mm
installation depth	2443 mm
motor output	3,0 kW
power connector	400 V/16 A
cable length to control	11 m
lifting time	≈ 35 sec.
lowering time	≈ 35 sec.

Platform support Alu Track 2.50 Duplo	102756
Support Swingarm 2.50-1500	112120
Installation cassette STEEL 1500 mm	2190XX
Installation cassette STEEL 1500 mm galvanized	2191XX
Lifting unit oil 5,0 t Duplo 5,0 t 1500 mm - K pre-assembled in installation cassette	111616
Lifting unit oil 5,0 t Duplo 5,0 t 1500 mm - H packed in wooden box	111617

ACCESSORIES

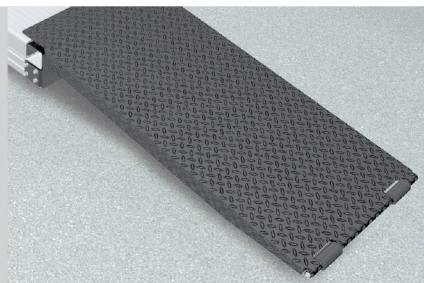

Drive on ramp

1250 mm
102347



Drive on stop

102349

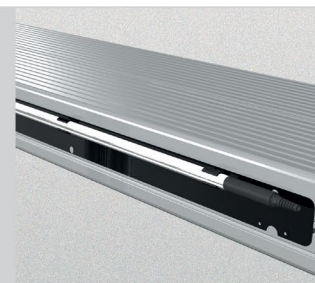

Lighting
LED

111598



Slide rail

4800 mm
102375

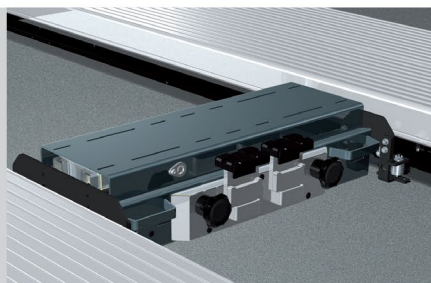

Axle lifter 2600 kg
pneumatic, without slide rails

105063



Compressed air supply

102407

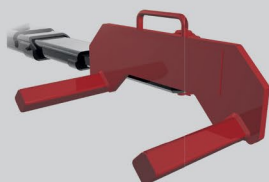

Wheel lifting device

(1 set / 4 pcs.)

GA490

ø wheel 590 - 690 mm

112051

GA550

ø wheel 670 - 770 mm

112052

Mounting adapter

Swingarm/Duplex

(1 set / 4 pcs.)

112146



1

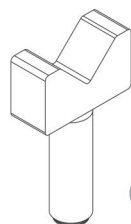

2



3

1 Stacking adapter extension
89 mm 127 mm

d 50 x 89 mm d 50 x 127 mm

109679 (1 Set / 4 Pieces) 109680 (1 Set / 4 Pieces)

2 Stacking adapter
V-shape

d 50 / 155 - 255 mm

112107 (1 Set / 4 Pieces)

3 Stacking adapter
U-form

d 50

110397 (1 Set / 4 Pieces)